

OKNO

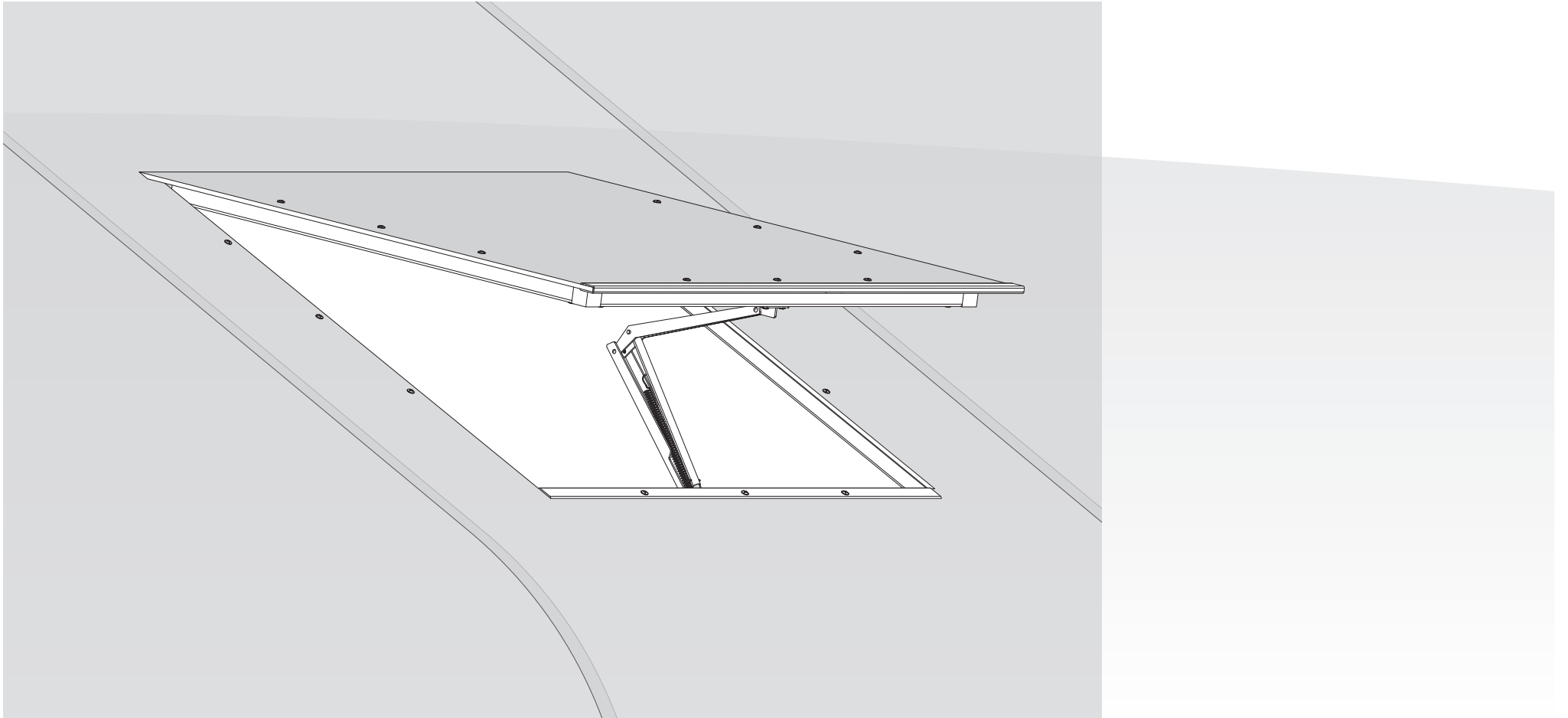

Lista elementów

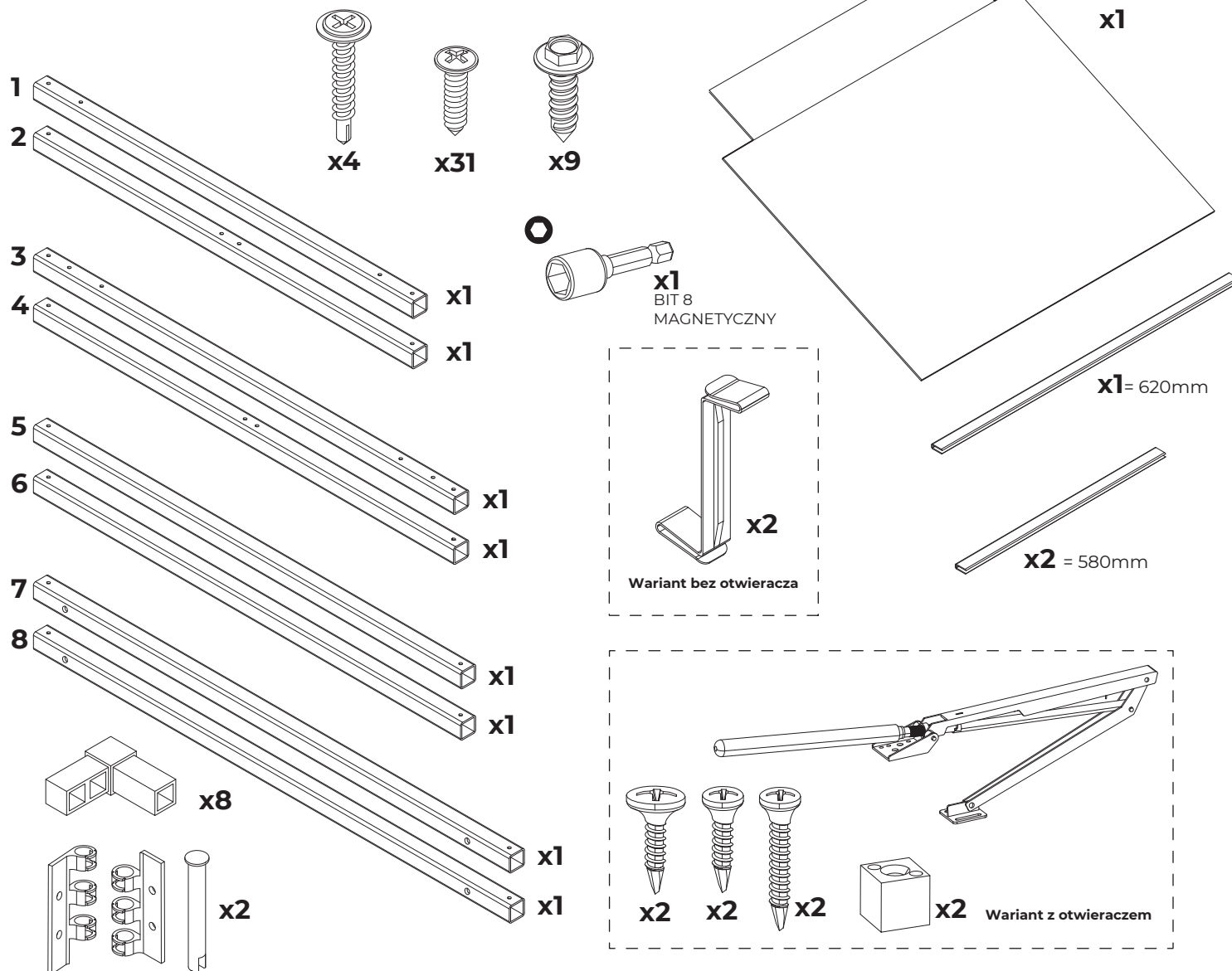

SPRAWDŹ CZY OPAKOWANIE ZAWIERA WSZYSTKIE ELEMENTY.
Zalecamy posegregowanie elementów przed ich montażem. Przyspieszy oraz ułatwi to pracę.

Narzędzia



Okno do samodzielnego montażu nie zawiera niektórych narzędzi do pracy. Skompletuj narzędzia przed przystąpieniem do pracy.

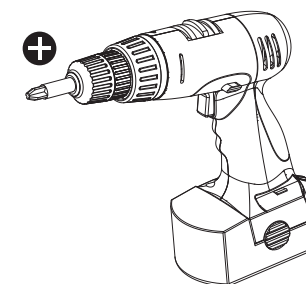

x1
WKREŃTARKA

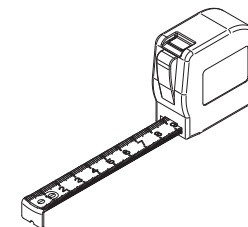

x1
MIARKA

1

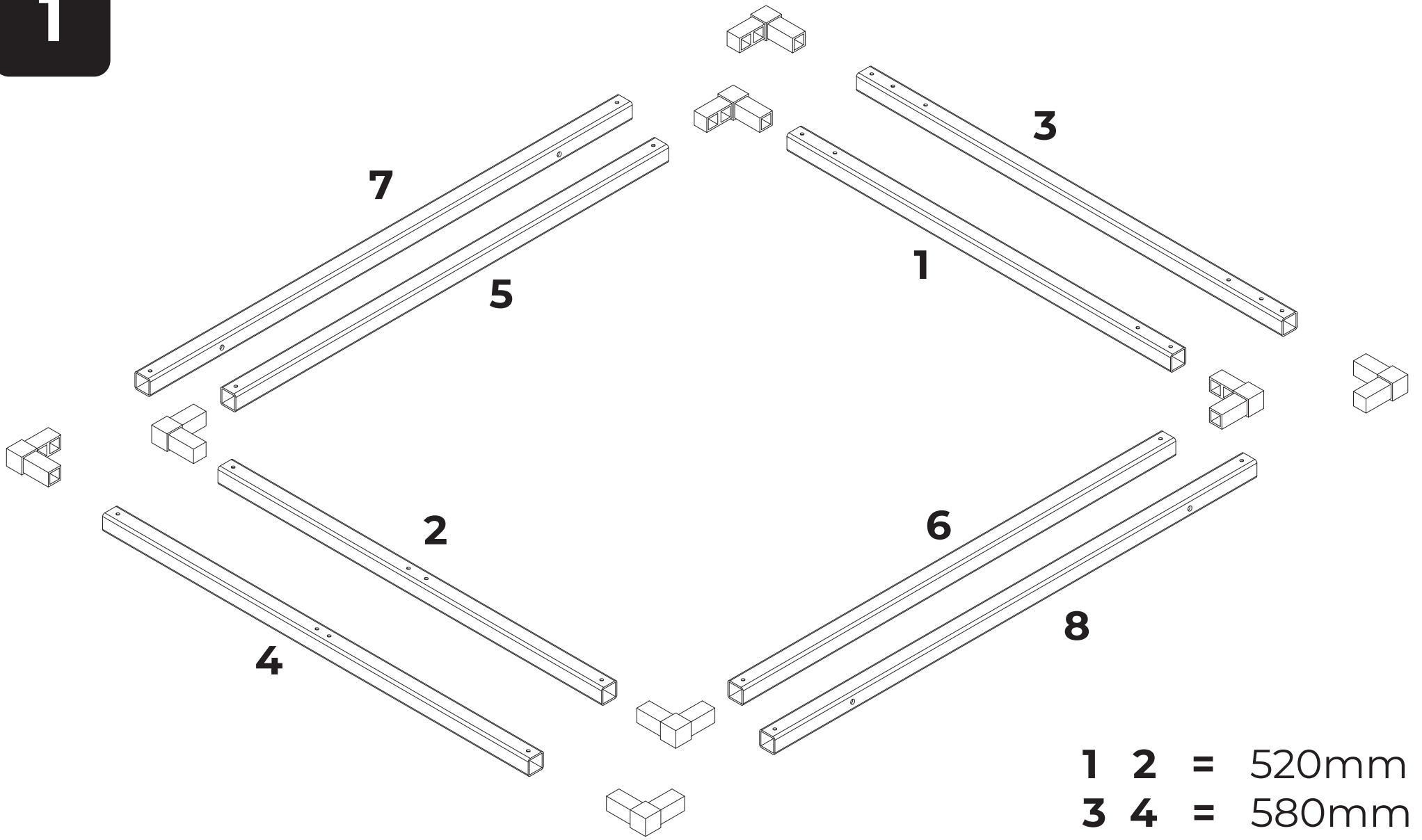

- 1 2 = 520mm**
- 3 4 = 580mm**
- 5 6 = 600mm**
- 7 8 = 660mm**

2

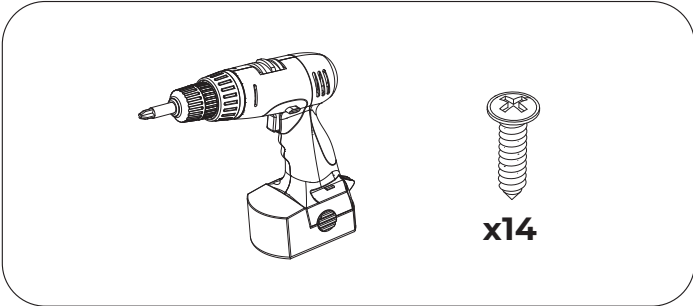
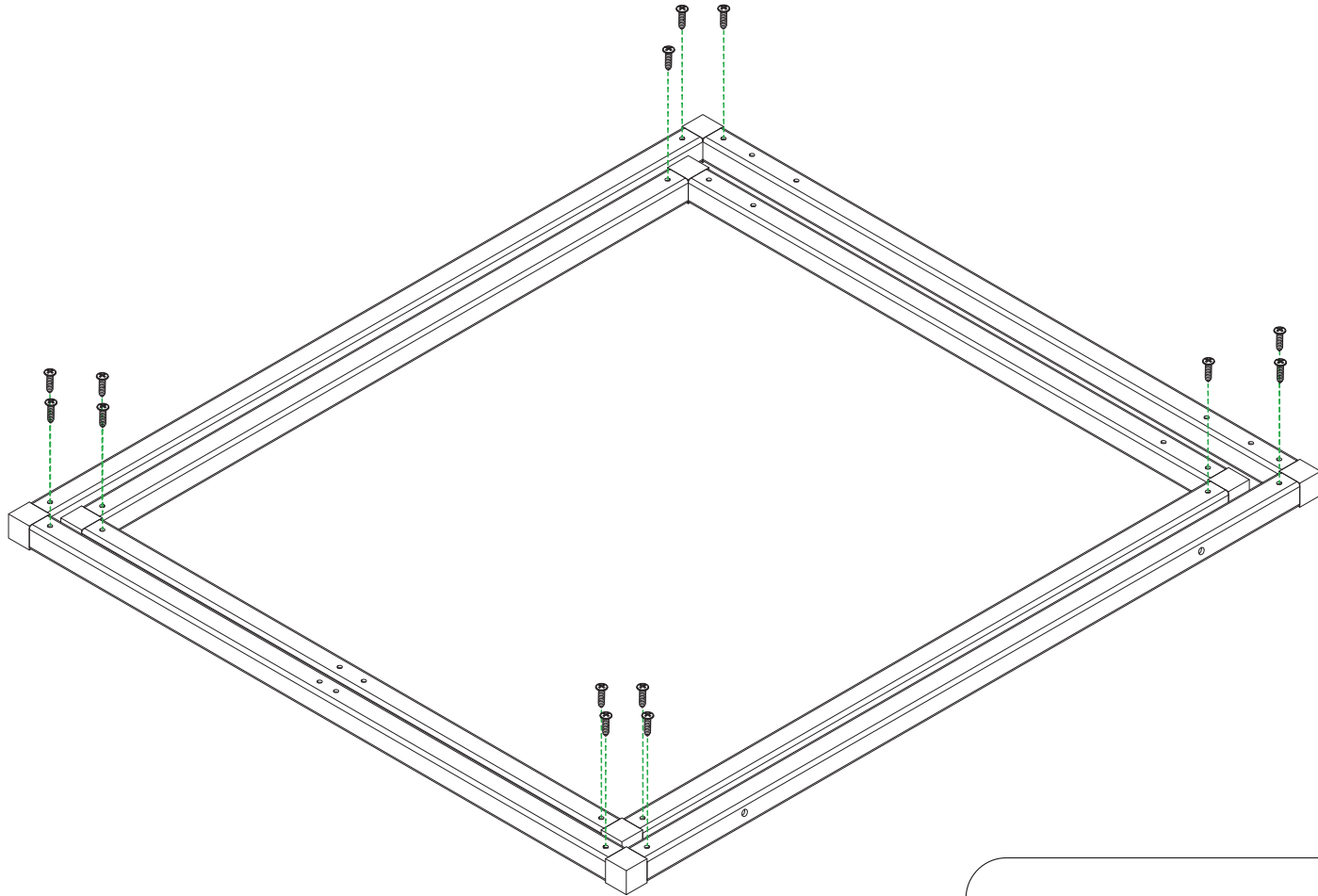

3

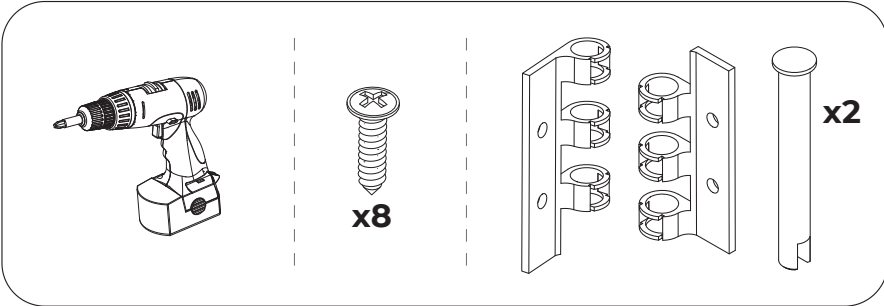
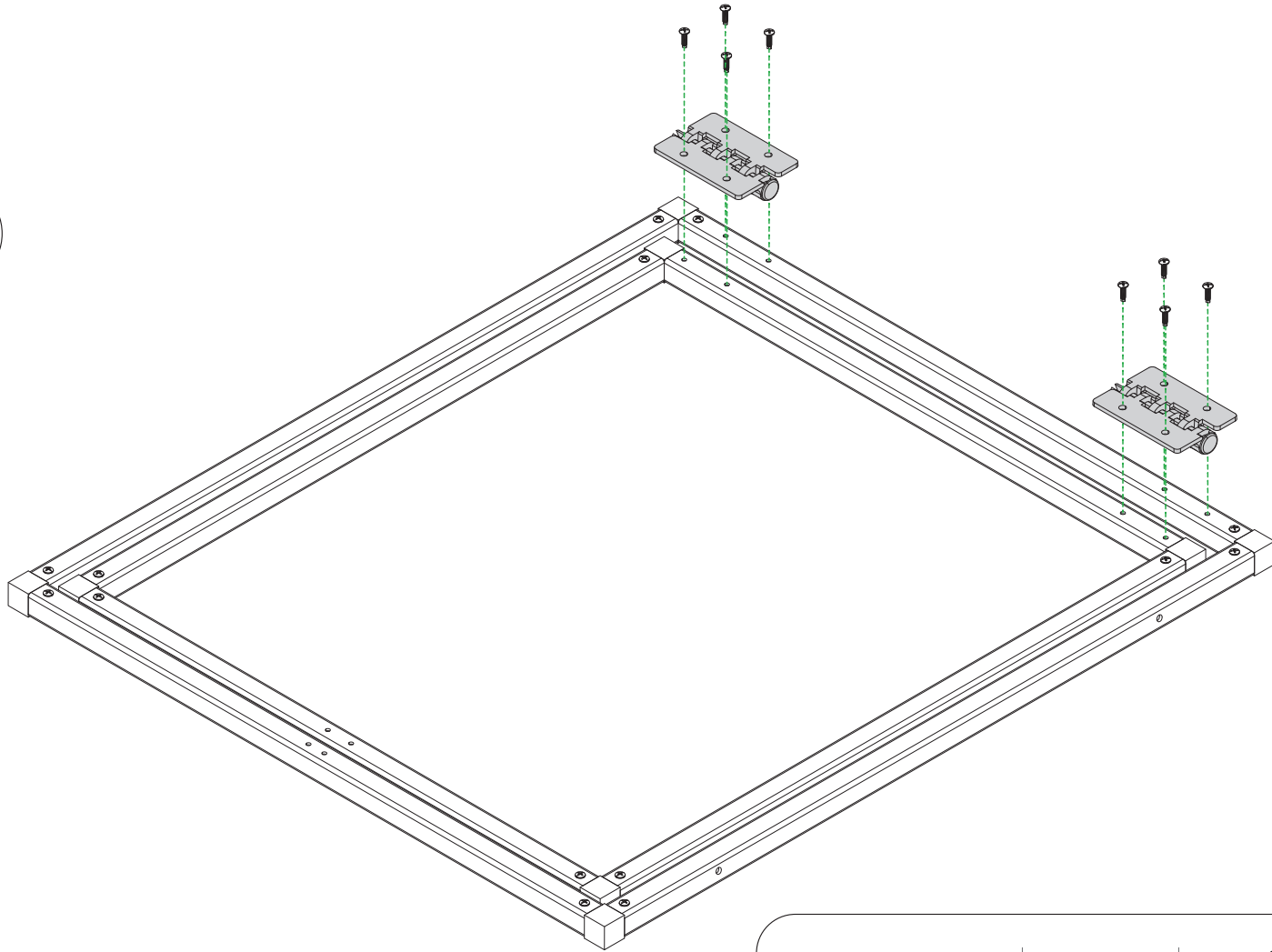
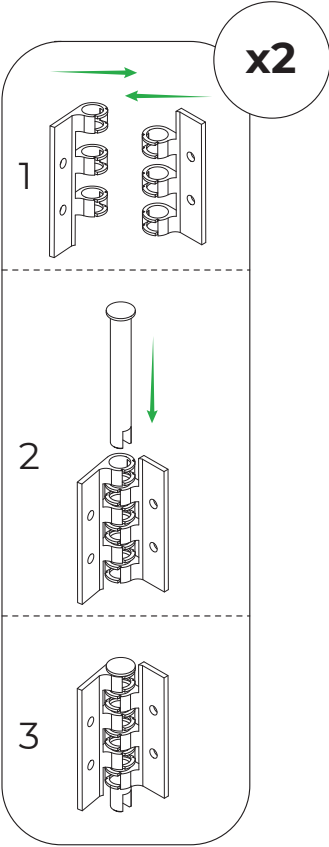

4a

Wariant z otwieraczem

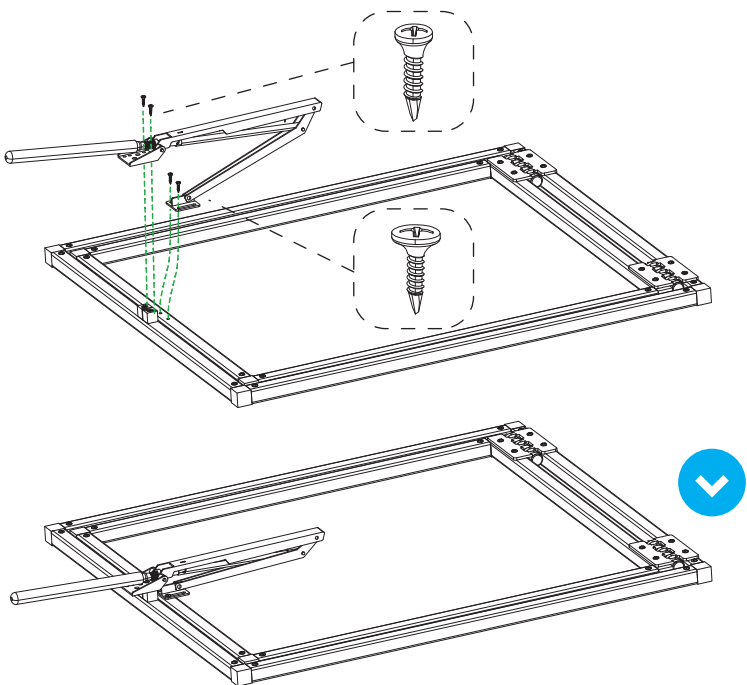
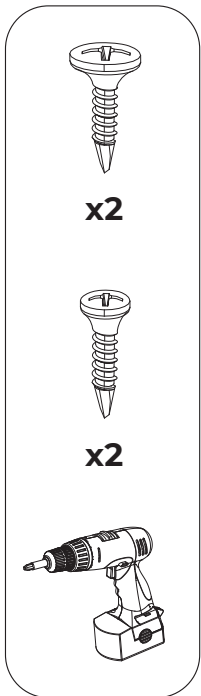
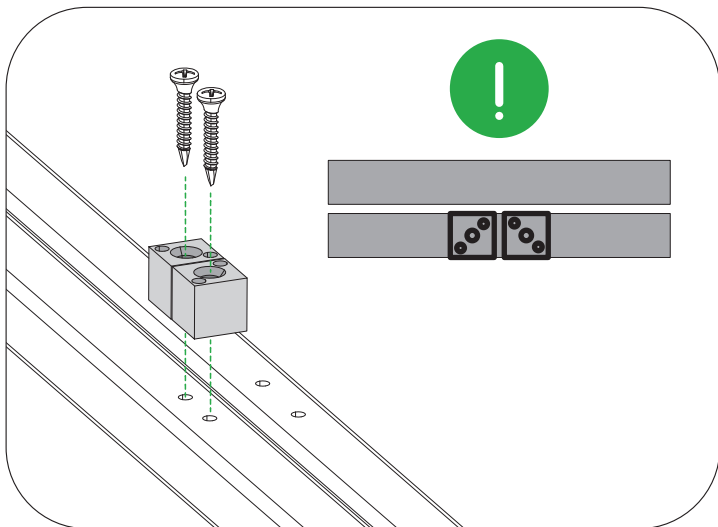
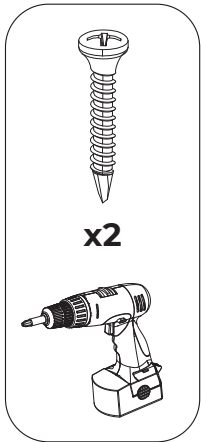
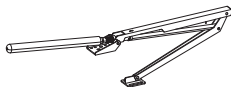

4b

Wariant bez otwieracza

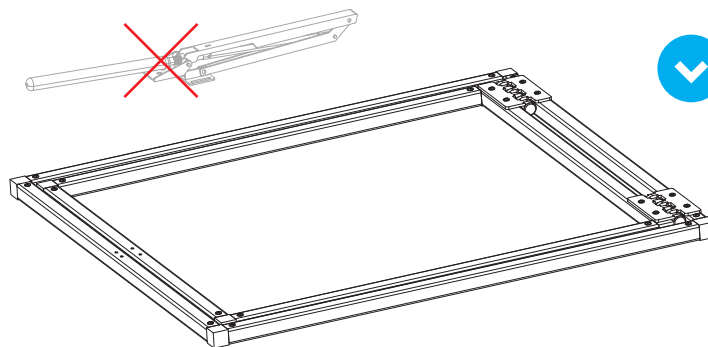
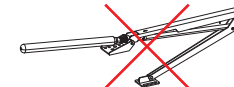

5a

Wariant z otwieraczem

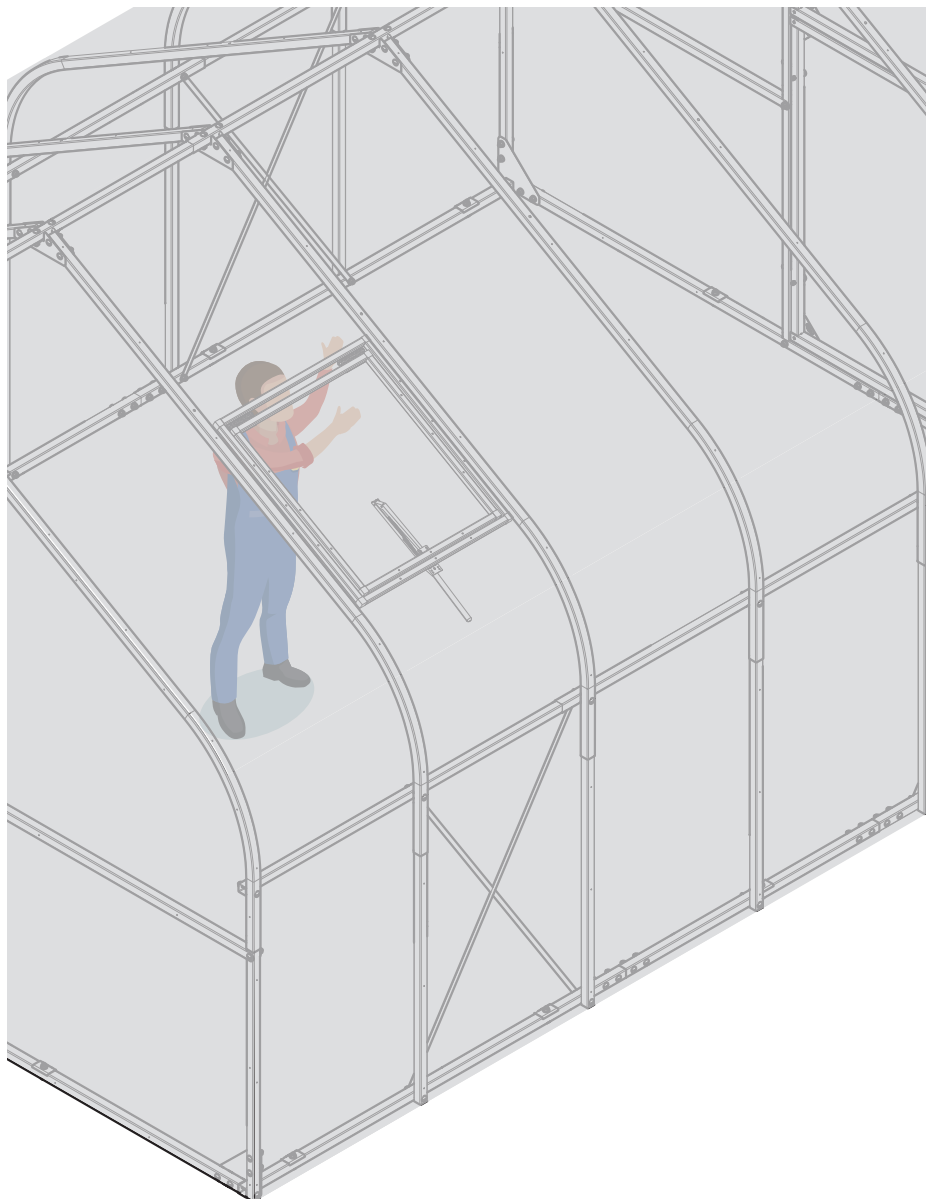
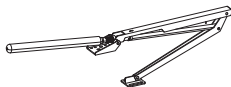

5b

Wariant bez otwieracza

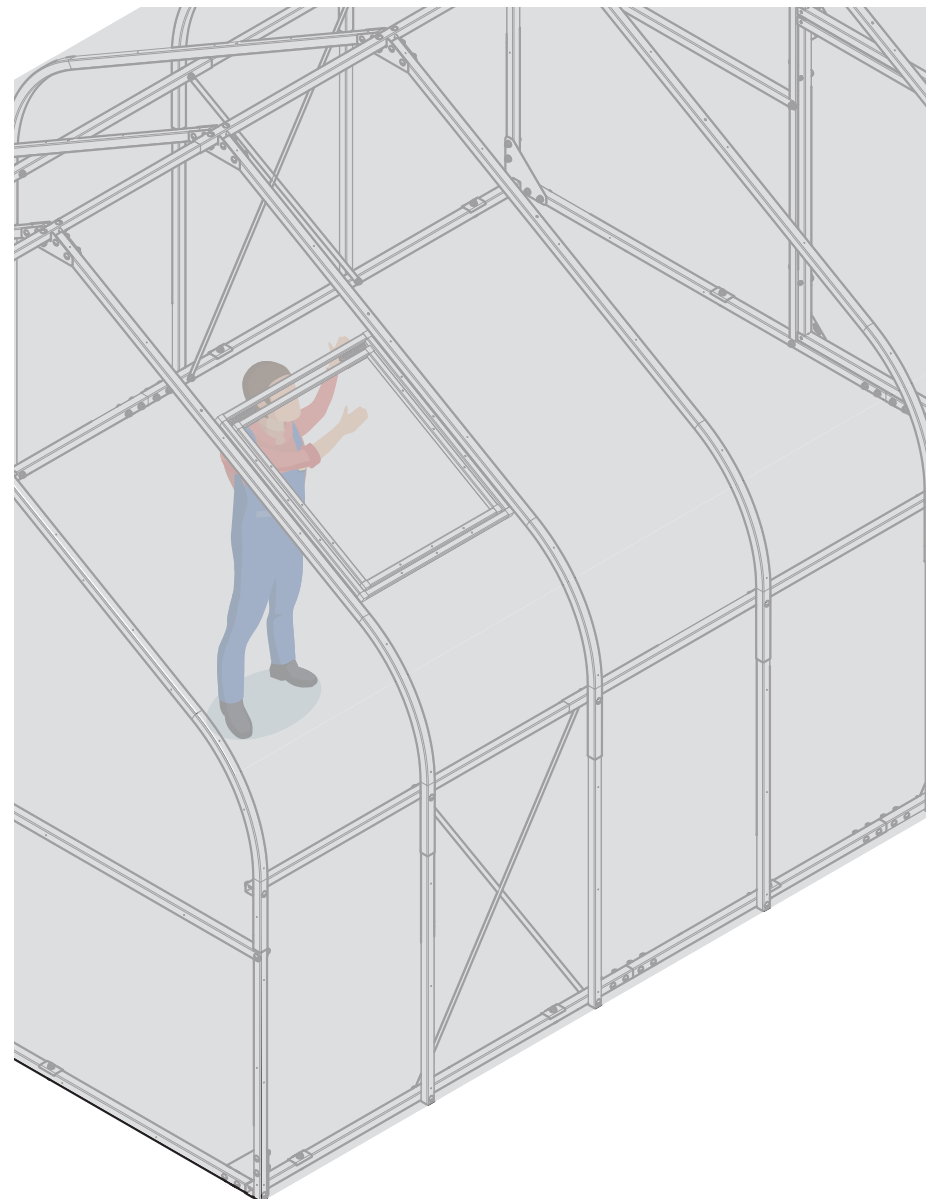

6a

Wariant z otwieraczem

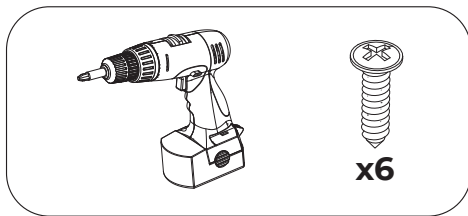
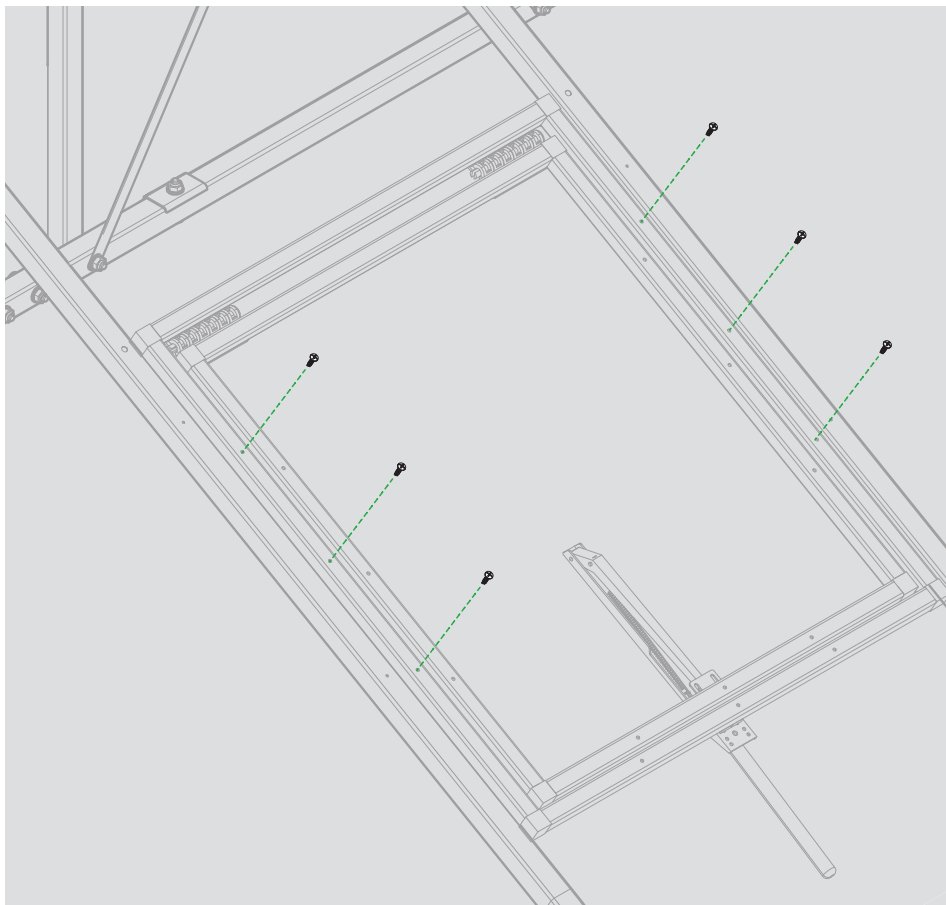
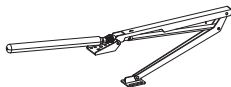

6b

Wariant bez otwieracza

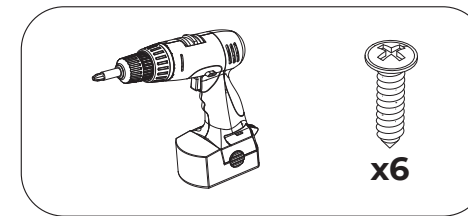
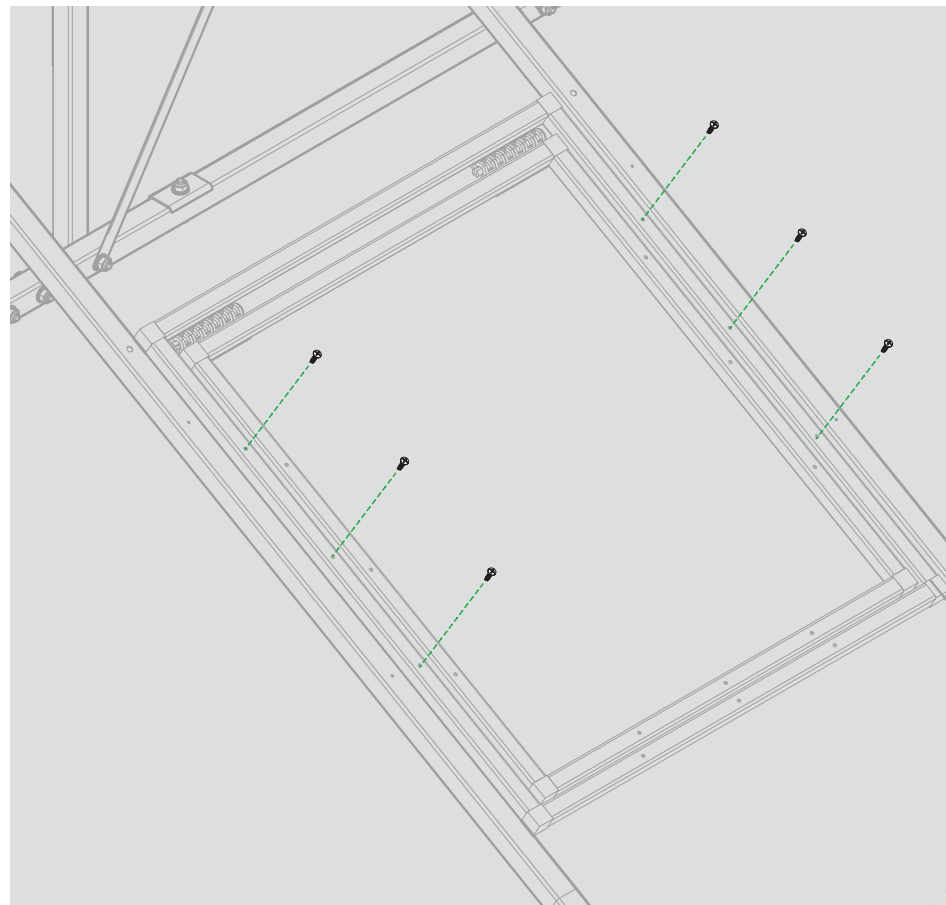
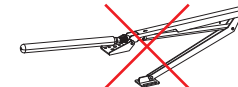

7

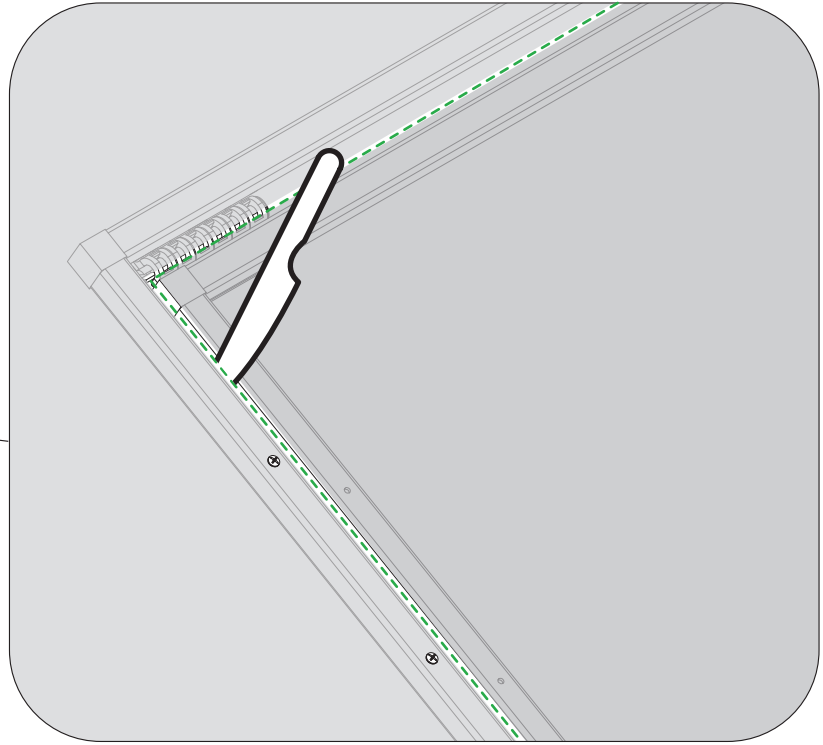
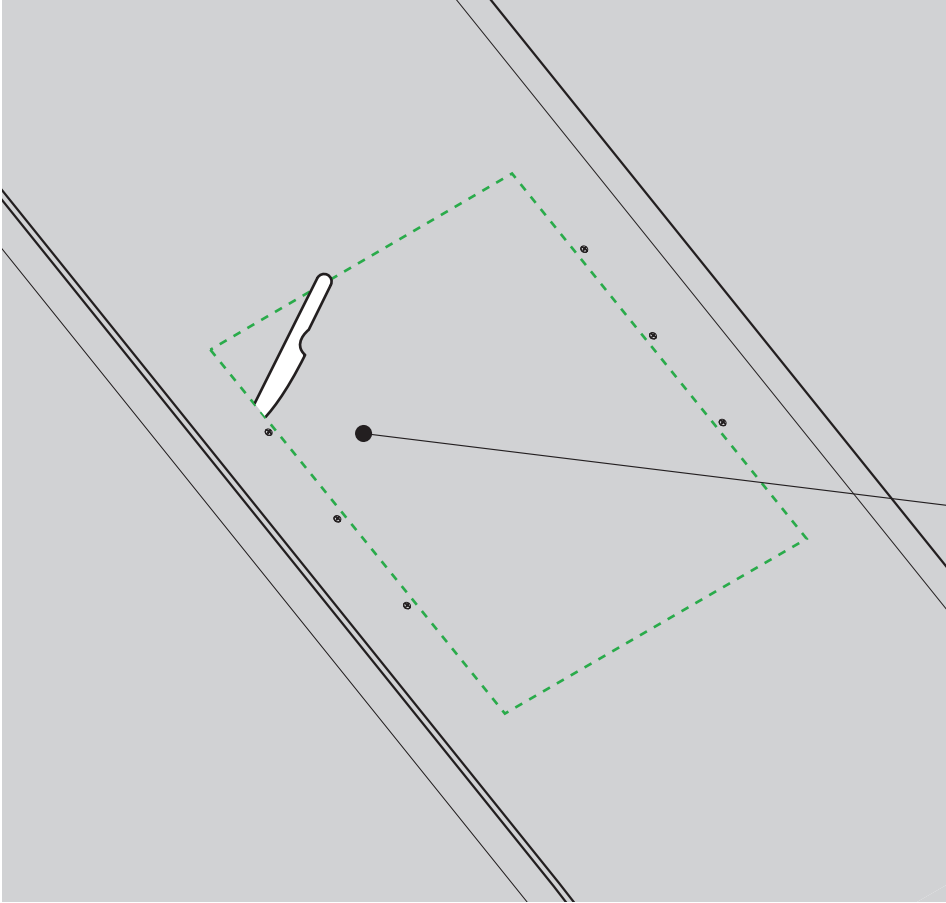

8

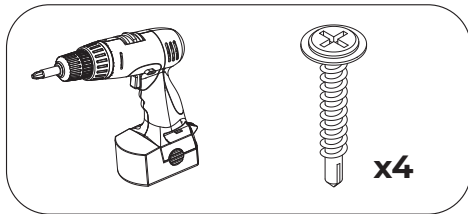
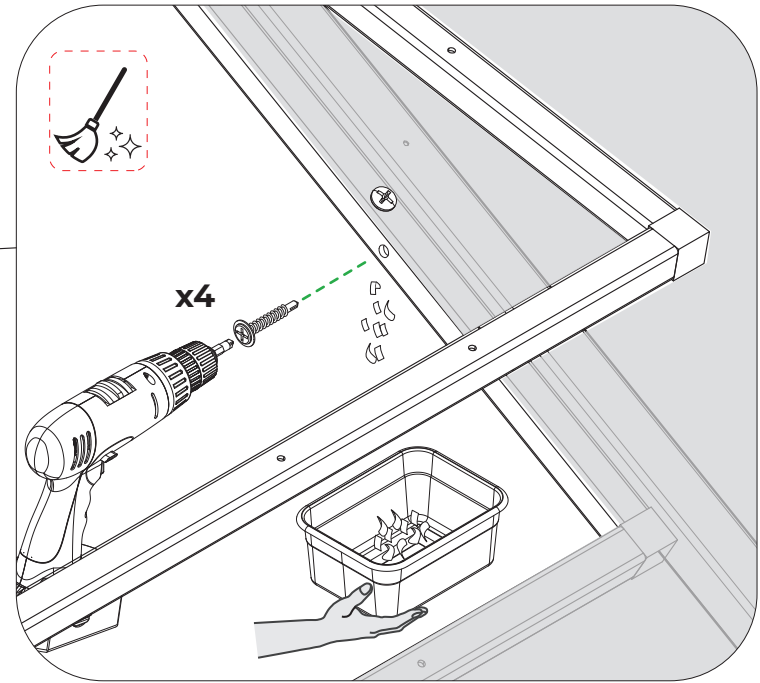
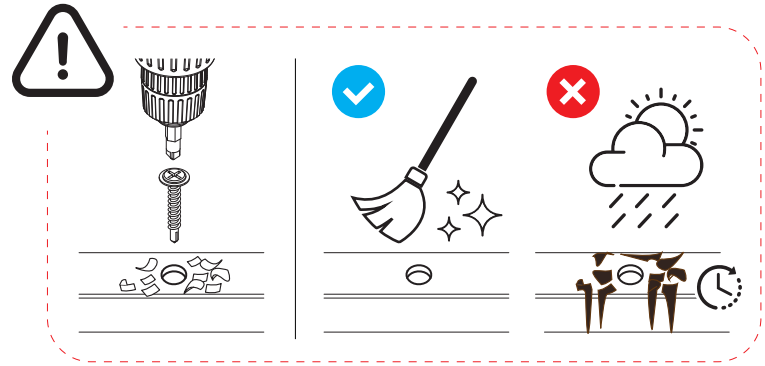
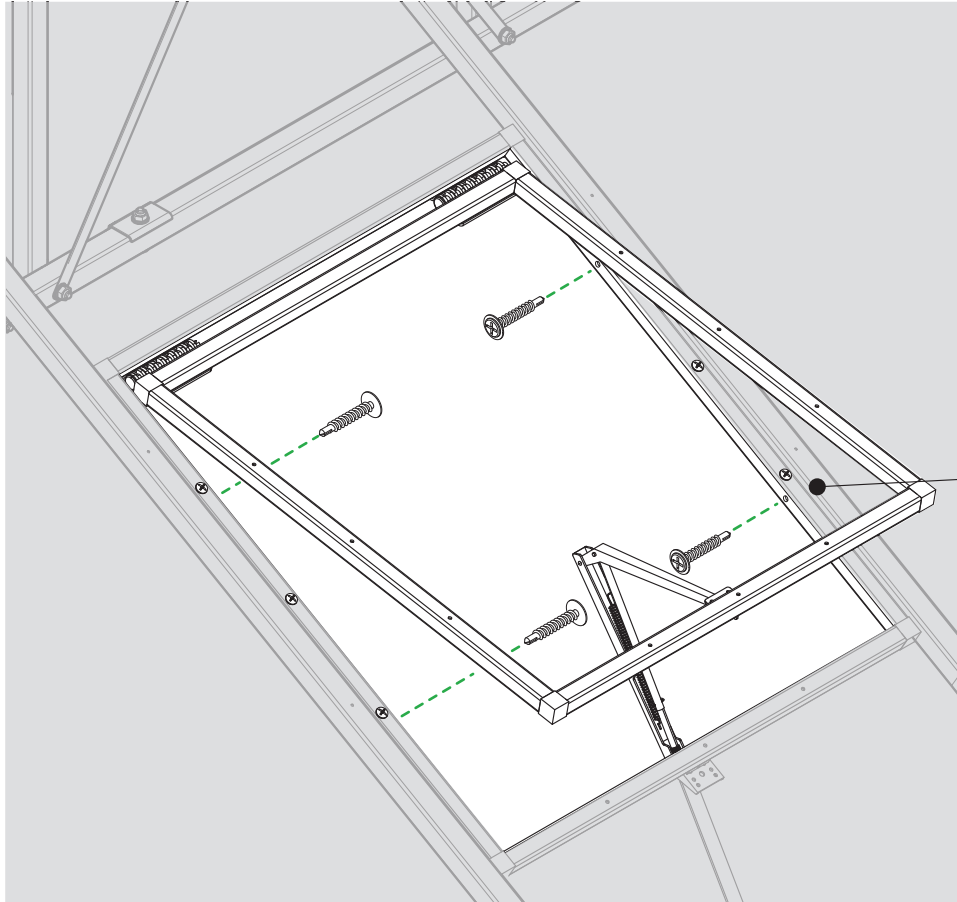

9

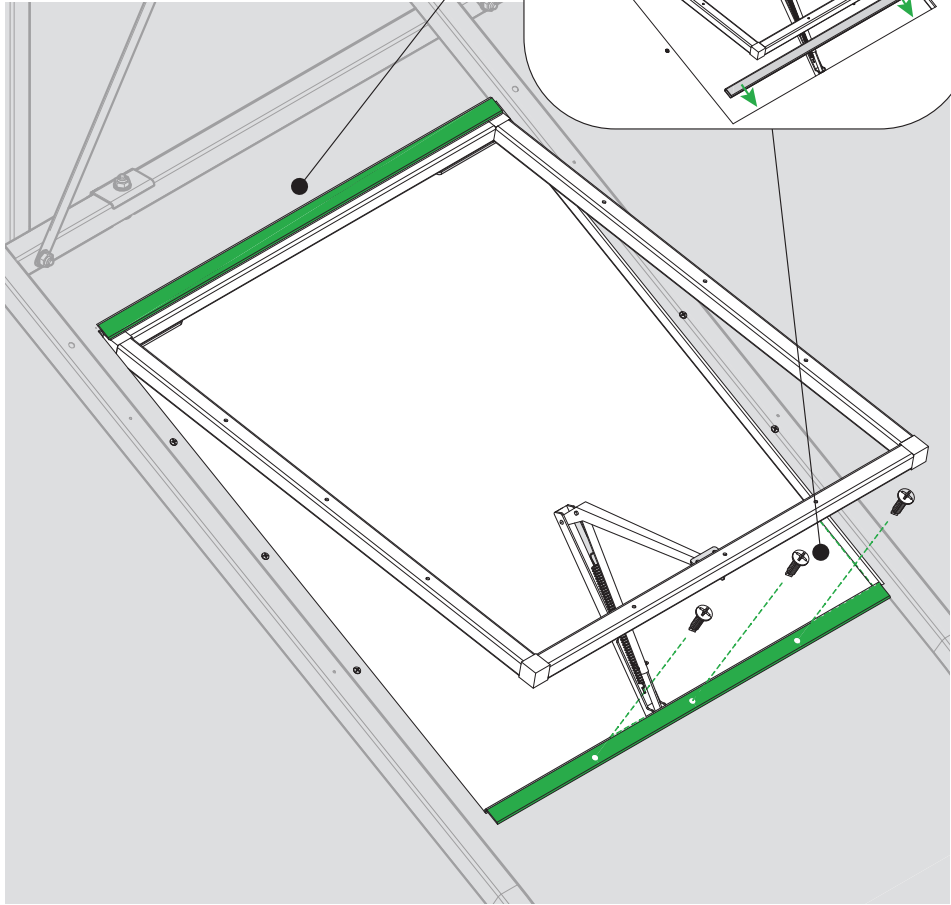

Diagram showing the tools and materials for step 9:

- A power drill.
- Two (x2) trim pieces, 580mm long.
- Three (x3) screws.

10

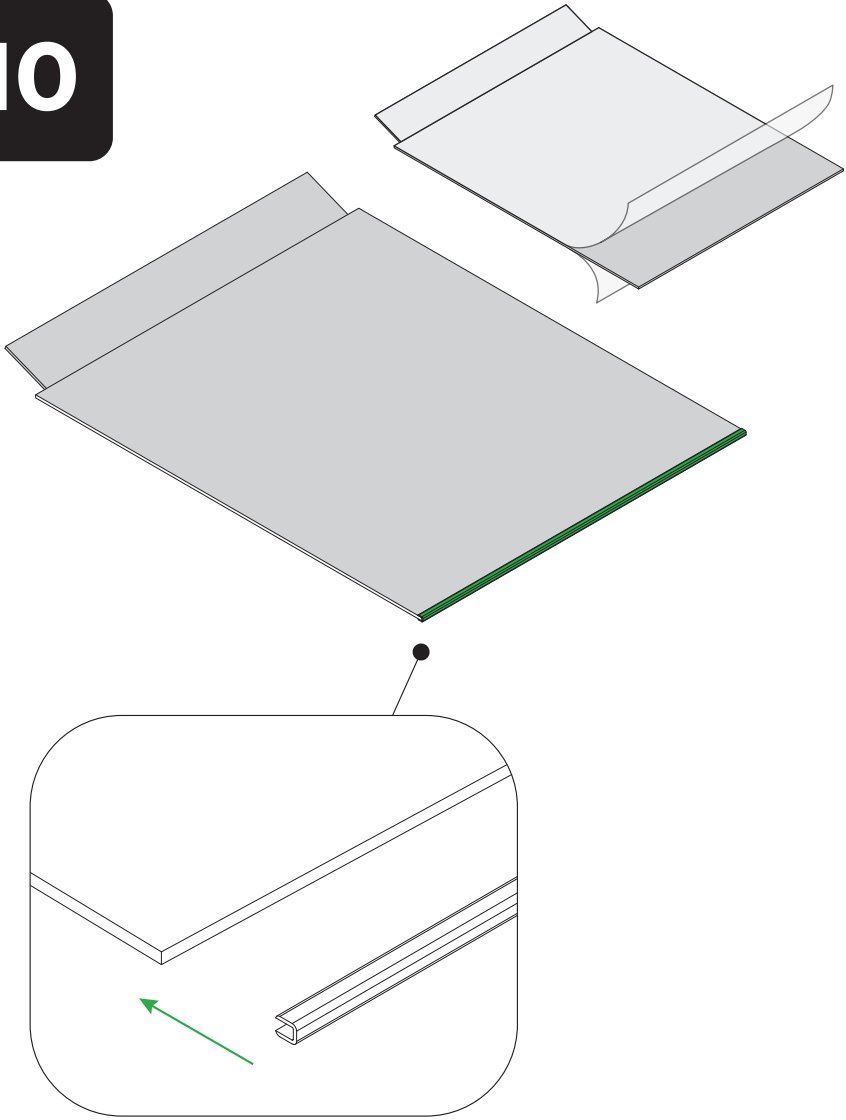
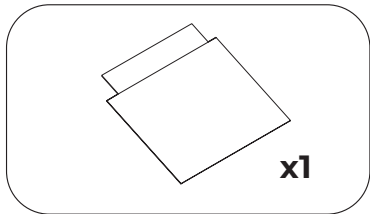
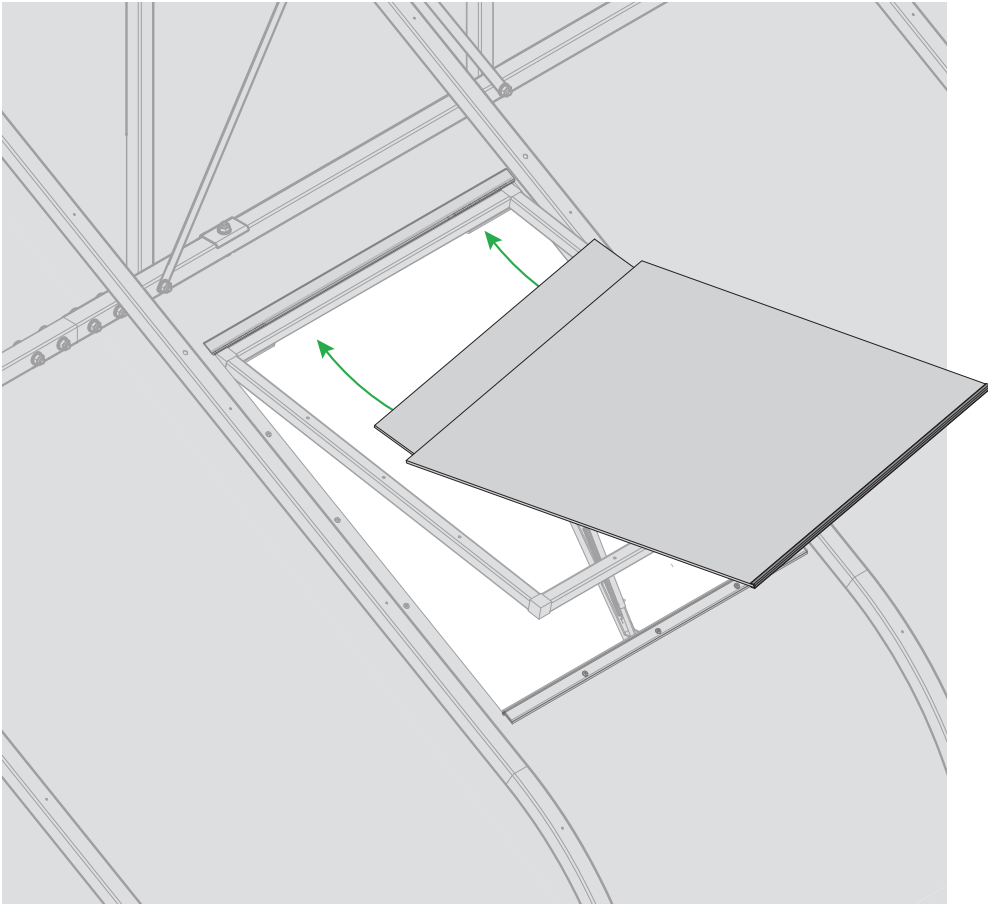

Diagram showing the material for step 10:

- One (x1) trim piece, 620mm long.

11



12

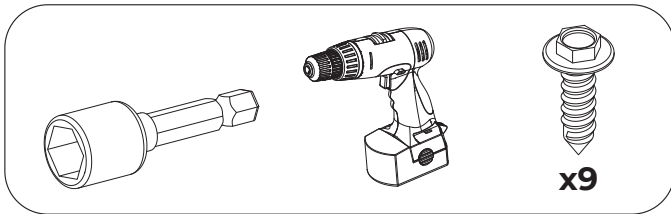
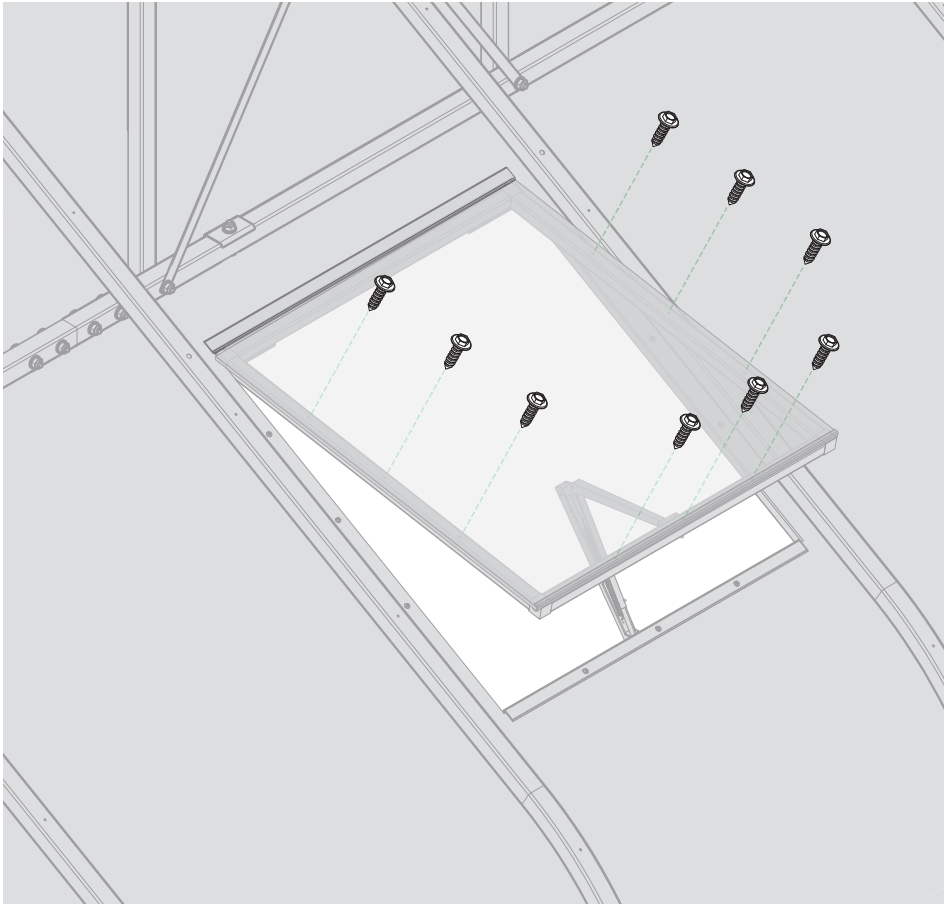

13a

Wariant z otwieraczem

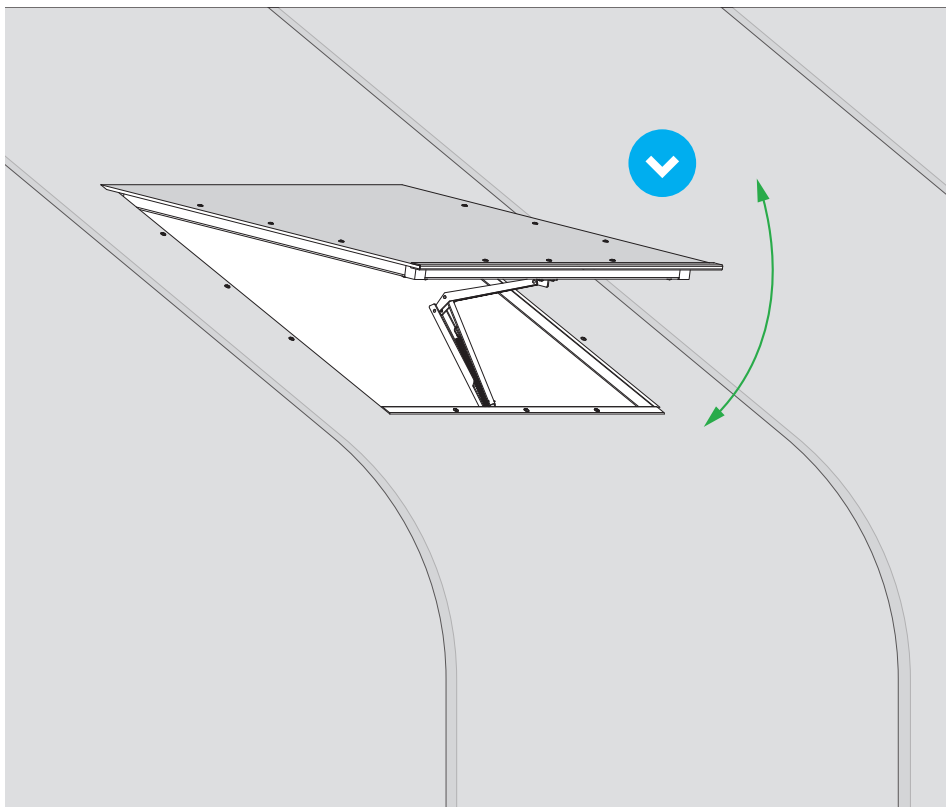
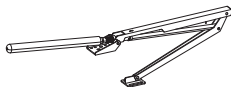

13b

Wariant bez otwieracza

