

UC Wkręty hartowane z łbem stożkowym

Wkręty hartowane do zastosowań w drewnie



Aprobaty

PN-EN 14566 + A1: 2012

DoP-EN14566

Reakcja na ogień: A1

Wytrzymałość na zginanie: spełnia

CE
10

Informacja o produkcie

Cechy i korzyści

- Konstrukcja gwintu pozwala na montaż w każdym rodzaju podłoża drewnianego
- Zoptymalizowany kształt łba z żebrami zaciskowymi zapewnia dokładny i bezodpryskowy montaż, nawet przy zamocowaniach blisko krawędzi powierzchni
- Podwójnie stożkowy łeb licuje się idealnie z powierzchnią drewna

Aplikacje

- Łączenie elementów drewnianych
- Mocowanie listew podłogowych
- Zamocowania drzwi i elementów metalowych
- Drobne zamocowania elementów
- Prace wykończeniowe

Materiał podłoża

Certyfikowane do:

- Płyta wiórowa
- Drewno

Instrukcja montażu

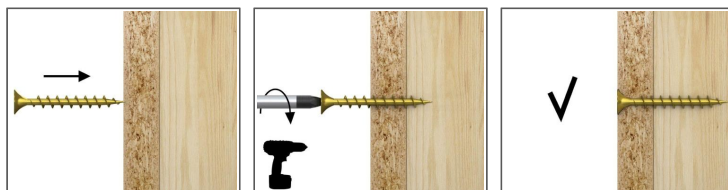

1. Wkręć wkręt prostopadle do podłoża do momentu zwrnienia się powierzchni łba z podłożem
2. Wkręty z gwintem częściowym umożliwiają dociskanie materiału mocowanego do podłoża
3. Wkręty z gwintem pełnym są zalecane przy montażu cienkich i drobnych elementów
4. Wkręty z łbem stożkowym mogą być zlicowane równo z podłożem

Informacja o produkcie

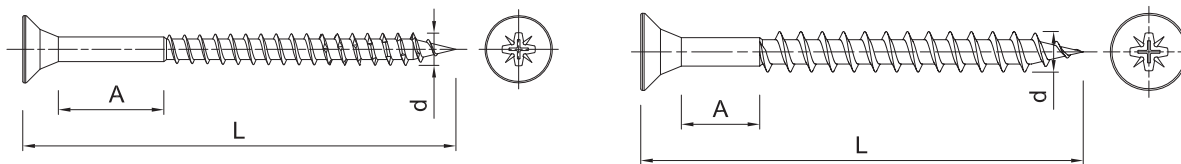

| Rozmiar | Produkt | Wkręt | | | | Element mocowany | | |
|---------|---------|----------|---------|-------------------|-------------------------|------------------------------|---------------------------------------|---|
| | | Średnica | Długość | Strefa bez gwintu | Typ końcówki montażowej | Max grubość | | |
| | | d | L | A | - | t _{fix} Profile PVC | t _{fix} Drewno konstrukcyjne | t _{fix} KCX z wkrętem do podłoży drewnianych |
| | | [mm] | [mm] | [mm] | - | [mm] | [mm] | [mm] |
| Ø2.5 | UC-2508 | 2.5 | 8 | - | PZ1 | - | - | - |
| | UC-2510 | 2.5 | 10 | - | PZ1 | - | - | - |
| | UC-2513 | 2.5 | 13 | - | PZ1 | 3 | 3 | - |
| | UC-2516 | 2.5 | 16 | - | PZ1 | 6 | 6 | - |
| Ø3 | UC-3012 | 3 | 12 | - | PZ1 | - | - | - |
| | UC-3016 | 3 | 16 | - | PZ1 | 4 | 4 | - |
| | UC-3020 | 3 | 20 | - | PZ1 | 8 | 8 | - |
| | UC-3025 | 3 | 25 | - | PZ1 | 13 | 13 | - |
| | UC-3030 | 3 | 30 | - | PZ1 | 18 | 18 | - |
| | UC-3035 | 3 | 35 | - | PZ1 | 23 | 23 | - |
| | UC-3040 | 3 | 40 | - | PZ1 | 28 | 28 | - |
| Ø3.5 | UC-3512 | 3.5 | 12 | - | PZ2 | - | - | - |
| | UC-3516 | 3.5 | 16 | - | PZ2 | 3 | 2 | - |
| | UC-3520 | 3.5 | 20 | - | PZ2 | 7 | 6 | - |
| | UC-3525 | 3.5 | 25 | - | PZ2 | 12 | 11 | - |
| | UC-3530 | 3.5 | 30 | - | PZ2 | 17 | 16 | - |
| | UC-3535 | 3.5 | 35 | - | PZ2 | 22 | 21 | - |
| | UC-3540 | 3.5 | 40 | - | PZ2 | 27 | 26 | - |
| | UC-3545 | 3.5 | 45 | - | PZ2 | 32 | 31 | - |
| Ø4 | UC-4016 | 4 | 16 | - | PZ2 | 1 | - | - |
| | UC-4020 | 4 | 20 | - | PZ2 | 5 | 4 | - |
| | UC-4025 | 4 | 25 | - | PZ2 | 10 | 9 | - |
| | UC-4030 | 4 | 30 | - | PZ2 | 15 | 14 | - |
| | UC-4035 | 4 | 35 | - | PZ2 | 20 | 19 | - |
| | UC-4040 | 4 | 40 | - | PZ2 | 25 | 24 | - |
| | UC-4045 | 4 | 45 | - | PZ2 | 30 | 29 | - |
| | UC-4050 | 4 | 50 | - | PZ2 | 35 | 34 | - |
| | UC-4060 | 4 | 60 | - | PZ2 | 45 | 44 | - |
| Ø4.5 | UC-4520 | 4.5 | 20 | - | PZ3 | 4 | 2 | - |
| | UC-4525 | 4.5 | 25 | - | PZ3 | 9 | 7 | - |
| | UC-4530 | 4.5 | 30 | - | PZ3 | 14 | 12 | - |
| | UC-4535 | 4.5 | 35 | - | PZ3 | 19 | 17 | - |
| | UC-4540 | 4.5 | 40 | - | PZ3 | 24 | 22 | - |
| | UC-4545 | 4.5 | 45 | - | PZ3 | 29 | 27 | - |
| | UC-4550 | 4.5 | 50 | - | PZ3 | 34 | 32 | - |
| | UC-4560 | 4.5 | 60 | - | PZ3 | 44 | 42 | - |
| Ø5 | UC-4570 | 4.5 | 70 | 15 | PZ3 | 54 | 52 | - |
| | UC-5020 | 5 | 20 | - | PZ3 | 2 | - | - |
| | UC-5025 | 5 | 25 | - | PZ3 | 7 | 5 | - |

Informacja o produkcji

| Rozmiar | Produkt | Wkręt | | | | Element mocowany | | |
|---------|----------|----------|---------|-------------------|-------------------------|------------------------------|---------------------------------------|---|
| | | Średnica | Długość | Strefa bez gwintu | Typ końcówki montażowej | Max grubość | | |
| | | d | L | A | - | t _{fix} Profile PVC | t _{fix} Drewno konstrukcyjne | t _{fix} KCX z wkrętem do podłoża drewnianych |
| | | [mm] | [mm] | [mm] | - | [mm] | [mm] | [mm] |
| Ø5 | UC-5030 | 5 | 30 | - | PZ3 | 12 | 10 | - |
| | UC-5035 | 5 | 35 | - | PZ3 | 17 | 15 | - |
| | UC-5040 | 5 | 40 | - | PZ3 | 22 | 20 | - |
| | UC-5045 | 5 | 45 | - | PZ3 | 27 | 25 | - |
| | UC-5050 | 5 | 50 | - | PZ3 | 32 | 30 | 70 |
| | UC-5060 | 5 | 60 | - | PZ3 | 42 | 40 | 80 |
| | UC-5070 | 5 | 70 | 17 | PZ3 | 52 | 50 | 90 |
| | UC-5080 | 5 | 80 | 20 | PZ3 | 62 | 60 | 100 |
| | UC-5090 | 5 | 90 | 27 | PZ3 | 72 | 70 | 110 |
| | UC-5100 | 5 | 100 | 40 | PZ3 | 82 | 80 | - |
| Ø6 | UC-6030 | 6 | 30 | - | PZ4 | 9 | 6 | - |
| | UC-6040 | 6 | 40 | - | PZ4 | 19 | 16 | - |
| | UC-6045 | 6 | 45 | - | PZ4 | 24 | 21 | - |
| | UC-6050 | 6 | 50 | - | PZ4 | 29 | 26 | 120 |
| | UC-6060 | 6 | 60 | - | PZ4 | 39 | 36 | 130 |
| | UC-6070 | 6 | 70 | 27 | PZ4 | 49 | 46 | 140 |
| | UC-6080 | 6 | 80 | 20 | PZ4 | 59 | 56 | 150 |
| | UC-6090 | 6 | 90 | 29 | PZ4 | 69 | 66 | 160 |
| | UC-6100 | 6 | 100 | 40 | PZ4 | 79 | 76 | 170 |
| | UC-6110 | 6 | 110 | 35 | PZ4 | 89 | 86 | 240 |
| | UC-6120 | 6 | 120 | 47 | PZ4 | 99 | 96 | 250 |
| | UC-6140 | 6 | 140 | 65 | PZ4 | 119 | 116 | 270 |
| | UC-6160 | 6 | 160 | 90 | PZ4 | 139 | 136 | 290 |
| | UC-6200 | 6 | 200 | 130 | PZ4 | 179 | 176 | - |
| Ø3 | UCK-3012 | 3 | 12 | - | PZ1 | - | - | - |
| Ø3.5 | UCK-3545 | 3.5 | 45 | - | PZ2 | 32 | 31 | - |
| Ø4.5 | UCK-4525 | 4.5 | 25 | - | PZ3 | 9 | 7 | - |
| Ø5 | UCK-5020 | 5 | 20 | - | PZ3 | 2 | - | - |
| Ø6 | UCK-6030 | 6 | 30 | - | PZ4 | 9 | 6 | - |
| | UCK-6110 | 6 | 110 | 35 | PZ4 | 89 | 86 | 240 |

Zalecenia montażowe

| Rozmiar | | | Ø2.5 | | Ø3 | | Ø3.5 | | Ø4 | | Ø4.5 | | Ø5 | | Ø6 | |
|-------------------------------|----------------------|-------------|----------------------|-------------|----------------------|-------------|----------------------|-------------|----------------------|-------------|----------------------|-------------|----------------------|-------------|----------------------|-------------|
| | Drewno konstrukcyjne | Profile PVC | Drewno konstrukcyjne | Profile PVC | Drewno konstrukcyjne | Profile PVC | Drewno konstrukcyjne | Profile PVC | Drewno konstrukcyjne | Profile PVC | Drewno konstrukcyjne | Profile PVC | Drewno konstrukcyjne | Profile PVC | Drewno konstrukcyjne | Profile PVC |
| Minimalna głębokość osadzenia | h _{nom} | [mm] | 10 | - | 12 | - | 14 | - | 16 | - | 18 | - | 20 | - | 24 | - |
| Min. grubość podłoża | h _{min} | [mm] | 20 | 3 | 24 | 3 | 28 | 3 | 32 | 3 | 36 | 3 | 40 | 3 | 48 | 3 |
| Min. rozstaw | s _{min} | [mm] | 30 | 30 | 30 | 30 | 30 | 30 | 30 | 30 | 30 | 30 | 30 | 30 | 30 | 30 |
| Min. odległość od krawędzi | c _{min} | [mm] | 30 | 30 | 30 | 30 | 30 | 30 | 30 | 30 | 30 | 30 | 30 | 30 | 30 | 30 |

Dane uproszczone dla pojedynczego zakotwienia

Dane dla pojedynczego zamocowania bez wpływu krawędzi i łączników sąsiadujących

| Rozmiar | ø2.5 | | ø3 | | ø3.5 | | ø4 | | ø4.5 | | ø5 | | ø6 | | |
|--|---------------------|--|---------------------|--|---------------------|--|--|---------------------|---------------------|--|---------------------|--|---------------------|--|------|
| Podłoże | Profi- le PVC | Drew- no kon- struk- cyjne | Profi- le PVC | Drew- no kon- struk- cyjne | Profi- le PVC | Drew- no kon- struk- cyjne | Drew- no kon- struk- cyjne | Profi- le PVC | Profi- le PVC | Drew- no kon- struk- cyjne | Profi- le PVC | Drew- no kon- struk- cyjne | Profi- le PVC | Drew- no kon- struk- cyjne | |
| OBCIĄŻENIE CHARAKTERYSTYCZNE_{RK} | | | | | | | | | | | | | | | |
| UC | [kN] | 0.30 | 0.95 | 0.60 | 0.90 | 0.70 | 1.10 | 1.35 | 0.75 | 0.75 | 2.20 | 0.80 | 2.25 | 0.90 | 3.05 |
| OBCIĄŻENIE OBLICZENIOWE_{RD} | | | | | | | | | | | | | | | |
| UC | [kN] | 0.15 | 0.30 | 0.30 | 0.30 | 0.35 | 0.35 | 0.45 | 0.35 | 0.35 | 0.70 | 0.40 | 0.75 | 0.45 | 1.00 |
| OBCIĄŻENIE ZALECANE_{REC} | | | | | | | | | | | | | | | |
| UC | [kN] | 0.11 | 0.21 | 0.21 | 0.21 | 0.25 | 0.25 | 0.32 | 0.25 | 0.25 | 0.50 | 0.29 | 0.54 | 0.32 | 0.71 |

Dane logistyczne

| Produkt | Wkręt | Ilość [szt] | | | Waga [kg] | | | Kody ean |
|---------|--------------|---------------------------|------------------------|--------|---------------------------|------------------------|--------|---------------|
| | Długość [mm] | Opakowanie jednostkowe | Opakowanie zbiorcze | Paleta | Opakowanie jednostkowe | Opakowanie zbiorcze | Paleta | |
| UC-2508 | 8 | 1000 | 24000 | | 0.37 | 8.9 | | 5906675312125 |
| UC-2510 | 10 | 1000 | 24000 | 768000 | 0.32 | 7.7 | 275.8 | 5906675312224 |
| UC-2513 | 13 | 1000 | 24000 | 768000 | 0.32 | 7.7 | 275.8 | 5906675312323 |
| UC-2516 | 16 | 1000 | 24000 | 768000 | 0.42 | 10.1 | 352.6 | 5906675312422 |
| UC-3012 | 12 | 1000 | 32000 | 768000 | 0.46 | 14.6 | 379.4 | 5906675310220 |
| UC-3016 | 16 | 1000 | 32000 | 768000 | 0.59 | 19.0 | 485.4 | 5906675310428 |
| UC-3020 | 20 | 1000 | 32000 | 768000 | 0.67 | 21.5 | 546.9 | 5906675310527 |
| UC-3025 | 25 | 1000 | 32000 | 768000 | 0.81 | 26.0 | 653.6 | 5906675310626 |
| UC-3030 | 30 | 1000 | 24000 | 576000 | 0.93 | 22.3 | 564.0 | 5906675310725 |
| UC-3035 | 35 | 1000 | 16000 | 384000 | 1.08 | 17.3 | 445.1 | 5906675310824 |
| UC-3040 | 40 | 1000 | 16000 | 384000 | 1.28 | 20.4 | 520.0 | 5906675310923 |
| UC-3512 | 12 | 1000 | 32000 | 768000 | 0.59 | 18.9 | 483.1 | 5906675311128 |
| UC-3516 | 16 | 1000 | 32000 | 768000 | 0.73 | 23.3 | 588.3 | 5906675311227 |
| UC-3520 | 20 | 1000 | 32000 | 768000 | 0.86 | 27.7 | 693.6 | 5906675311425 |
| UC-3525 | 25 | 1000 | 24000 | 576000 | 1.12 | 26.9 | 675.1 | 5906675311524 |
| UC-3530 | 30 | 1000 | 16000 | 384000 | 1.27 | 20.2 | 515.8 | 5906675311623 |
| UC-3535 | 35 | 1000 | 16000 | 384000 | 1.45 | 23.2 | 587.6 | 5906675311722 |
| UC-3540 | 40 | 1000 | 12000 | 288000 | 1.64 | 19.6 | 501.2 | 5906675311821 |
| UC-3545 | 45 | 500 | 8000 | 192000 | 0.94 | 15.0 | 389.8 | 5906675311920 |
| UC-3550 | 50 | 500 | 6000 | 144000 | 1.04 | 12.5 | 330.7 | 5906675312026 |
| UC-4016 | 16 | 1000 | 16000 | 384000 | 0.96 | 15.3 | 397.5 | 5906675313221 |
| UC-4020 | 20 | 1000 | 24000 | 576000 | 1.17 | 28.0 | 701.0 | 5906675313429 |
| UC-4025 | 25 | 1000 | 16000 | 384000 | 1.42 | 22.7 | 575.3 | 5906675313528 |
| UC-4030 | 30 | 500 | 8000 | 192000 | 0.83 | 13.2 | 347.2 | 5906675313627 |
| UC-4035 | 35 | 500 | 12000 | 288000 | 0.93 | 22.4 | 567.4 | 5906675313726 |
| UC-4040 | 40 | 500 | 8000 | 192000 | 1.06 | 17.0 | 438.6 | 5906675313825 |
| UC-4045 | 45 | 500 | 8000 | 192000 | 1.18 | 18.8 | 482.0 | 5906675313924 |
| UC-4050 | 50 | 500 | 6000 | 144000 | 1.31 | 15.8 | 408.4 | 5906675314020 |
| UC-4060 | 60 | 500 | 6000 | 144000 | 1.50 | 18.0 | 462.6 | 5906675314129 |
| UC-4070 | 70 | 250 | 4000 | 96000 | 0.91 | 14.5 | 377.9 | 5906675314228 |
| UC-4520 | 20 | 500 | 9000 | 216000 | 0.82 | 14.8 | 385.6 | 5906675315126 |
| UC-4525 | 25 | 500 | 9000 | 216000 | 0.99 | 17.8 | 457.3 | 5906675315225 |
| UC-4530 | 30 | 500 | 12000 | 288000 | 1.04 | 24.9 | 627.9 | 5906675315324 |
| UC-4535 | 35 | 500 | 8000 | 192000 | 1.25 | 19.9 | 508.1 | 5906675315423 |
| UC-4540 | 40 | 500 | 8000 | 192000 | 1.48 | 23.6 | 596.8 | 5906675315522 |
| UC-4545 | 45 | 250 | 6000 | 144000 | 0.75 | 18.1 | 464.3 | 5906675315621 |
| UC-4550 | 50 | 250 | 4000 | 96000 | 0.87 | 14.0 | 365.6 | 5906675315720 |
| UC-4560 | 60 | 250 | 4000 | 96000 | 1.00 | 16.0 | 413.6 | 5906675315829 |

Dane logistyczne

| Produkt | Wkręt | Ilość [szt] | | | Waga [kg] | | | Kody ean |
|----------|--------------|------------------------|---------------------|--------|------------------------|---------------------|--------|---------------|
| | Długość [mm] | Opakowanie jednostkowe | Opakowanie zbiorcze | Paleta | Opakowanie jednostkowe | Opakowanie zbiorcze | Paleta | |
| UC-4570 | 70 | 250 | 3000 | 72000 | 1.20 | 14.4 | 375.6 | 5906675315928 |
| UC-5020 | 20 | 500 | 16000 | 384000 | 1.02 | 32.6 | 813.4 | 5906675316123 |
| UC-5025 | 25 | 500 | 12000 | 288000 | 1.11 | 26.7 | 669.9 | 5906675316222 |
| UC-5030 | 30 | 500 | 8000 | 192000 | 1.33 | 21.3 | 542.3 | 5906675316321 |
| UC-5035 | 35 | 500 | 8000 | 192000 | 1.52 | 24.3 | 612.1 | 5906675316420 |
| UC-5040 | 40 | 250 | 4000 | 96000 | 0.84 | 13.5 | 353.7 | 5906675316529 |
| UC-5045 | 45 | 250 | 6000 | 144000 | 0.97 | 23.4 | 590.4 | 5906675316628 |
| UC-5050 | 50 | 200 | 3200 | 76800 | 0.89 | 14.2 | 369.8 | 5906675316727 |
| UC-5060 | 60 | 200 | 2400 | 57600 | 1.03 | 12.3 | 325.2 | 5906675316826 |
| UC-5070 | 70 | 200 | 2400 | 57600 | 1.17 | 14.1 | 367.2 | 5906675316925 |
| UC-5080 | 80 | 100 | 1600 | 38400 | 0.67 | 10.7 | 286.5 | 5906675317021 |
| UC-5090 | 90 | 100 | 2400 | 57600 | 0.71 | 17.0 | 437.8 | 5906675317120 |
| UC-5100 | 100 | 100 | 1600 | 38400 | 0.84 | 13.5 | 353.7 | 5906675317229 |
| UC-6030 | 30 | 200 | 6400 | 153600 | 0.82 | 26.4 | 662.8 | 5906675318127 |
| UC-6040 | 40 | 200 | 4800 | 115200 | 1.06 | 25.5 | 642.9 | 5906675318325 |
| UC-6045 | 45 | 200 | 3600 | 86400 | 1.16 | 20.9 | 531.1 | 5906675318424 |
| UC-6050 | 50 | 200 | 3200 | 76800 | 1.28 | 20.5 | 522.7 | 5906675318523 |
| UC-6060 | 60 | 200 | 2400 | 57600 | 1.50 | 18.0 | 462.3 | 5906675318622 |
| UC-6070 | 70 | 100 | 2400 | 57600 | 0.86 | 20.7 | 527.1 | 5906675318721 |
| UC-6080 | 80 | 100 | 2400 | 57600 | 0.98 | 23.5 | 594.5 | 5906675318820 |
| UC-6090 | 90 | 100 | 1200 | 28800 | 1.08 | 13.0 | 341.0 | 5906675318929 |
| UC-6100 | 100 | 100 | 1200 | 28800 | 1.20 | 14.4 | 375.6 | 5906675319025 |
| UC-6110 | 110 | 100 | 1200 | 28800 | 1.31 | 15.8 | 408.1 | 5906675319124 |
| UC-6120 | 120 | 100 | 1200 | 28800 | 1.42 | 17.1 | 439.2 | 5906675319223 |
| UC-6140 | 140 | 100 | 1200 | 28800 | 1.64 | 19.7 | 502.0 | 5906675319421 |
| UC-6160 | 160 | 100 | 1200 | 28800 | 1.87 | 22.4 | 567.4 | 5906675319520 |
| UC-6200 | 200 | 100 | 800 | 19200 | 2.3 | 18.4 | 472.2 | 5906675319629 |
| UCK-3012 | 12 | 10 | 10 | 720 | 10.3 | 10.3 | 770.2 | 5906675166261 |
| UCK-3545 | 45 | 10 | 10 | 360 | 10.4 | 10.4 | 405.8 | 5906675166520 |
| UCK-4525 | 25 | 10 | 10 | 480 | 10.1 | 10.1 | 515.9 | 5906675166780 |
| UCK-5020 | 20 | 10 | 10 | 480 | 10.3 | 10.3 | 525.0 | 5906675167541 |
| UCK-6030 | 30 | 10 | 10 | 720 | 10.1 | 10.1 | 756.1 | 5906675288376 |
| UCK-6110 | 110 | 10 | 10 | 720 | 10.4 | 10.4 | 775.6 | 5906675291895 |